



DESIGNER COLLECTION TUBS
MODEL # PET300

Jentle Pet® 2
Pet Spa For Dogs
59.5" x 38" x 31.5"

Installation:

Alcove

cannot be undermounted

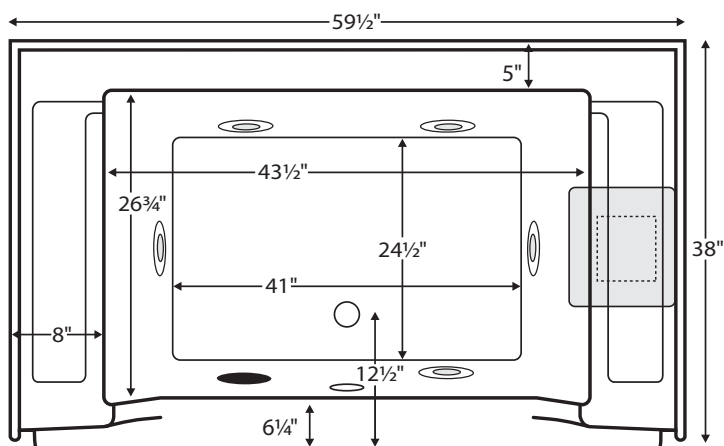

NOTE: Pump and fixtures come standard on the right. Left-hand placement is available by special request.

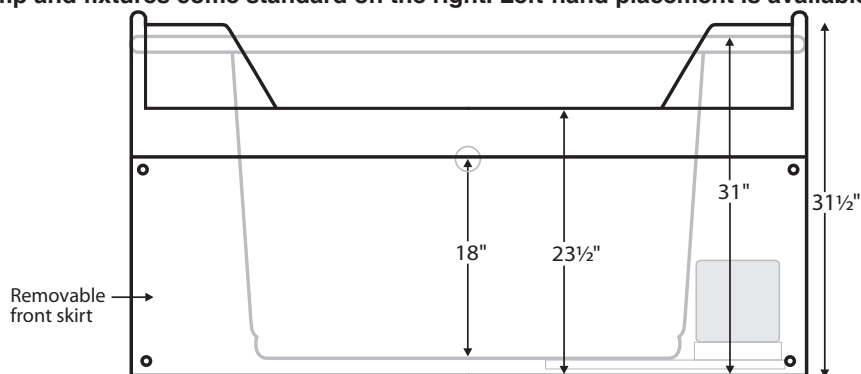

GENERAL SPECIFICATIONS:

Material	Acrylic
Plumbed Weight	163 lbs / 73.93 kg
Soaker Weight	147 lbs / 66.57 kg
Average Fill	61 gal to above jet level
Maximum Fill	88 gal to top

ELECTRICAL SPECIFICATIONS:

Required Electrical Service	110 Volt
Whirlpool	1-15 amp GFCI

CSA Certified C/US; ANSI Z124.1 for plastic tubs and ANSI 112.19.7 for whirlpool components.

IMPORTANT ORDERING & INSTALLATION INFORMATION:

- Before ordering or installing, please consider future access to equipment.
- Suction and control locations may vary.
- Specifications and configurations are subject to change without notice.
- Measurements are $\pm 1/2$ " and are subject to change without notice.
- Measurements herein supersede all others published prior to publication date shown below.

See the "Designer Collection Tubs Installation & Operation Manual" included with tub delivery or go to mtibaths.com/support/installation_operation/manuals for all the information necessary to install and operate the tub.

MTI's Customer Service Department is available Monday-Friday 8am-6pm EST at 800-783-8827 or customerservice@mtibaths.com to answer any questions pertaining to ordering or installation.

Hydrotherapy Packages	Package Contents	Colors	Part #	MSRP
Soaker Packages <i>Soaker</i> Soaker Packages <i>Soaker with Fixtures</i>	Soaking bath, no jets or hardware installed.	White	PET300S	\$2,584
		Bone/Biscuit/Almond	PET300SB	\$2,711
		Other Colors*	PET300SGRP1	\$2,863
	Soaking bath, no jets. Includes: - Filler spout, hot/cold single-lever mixing valve, hand-held shower, Breda Valve diverter, - 2 suction-mounted movable retaining rings and 1 adjustable loop-style restraint.	White	PET300SC	\$3,628
		Bone/Biscuit/Almond	PET300SCB	\$3,909
		Other Colors*	PET300SCGRP1	\$4,081
Whirlpool Packages <i>Whirlpool with Customer-Supplied Hardware</i> Whirlpool Packages <i>Whirlpool with Fixtures</i>	Includes: - Whirlpool system with 5 point-massage jets, 1-bhp pump - Fill-Flush® cleaning system - Suction fitting with removable screen filter to trap hair, - Installation of any customer-supplied fixtures. - Breda Valve Diverter (in chrome finish) - Unit will fill through the jets. - 2 suction-mounted movable retaining rings and 1 adjustable loop-style restraint.	White	PET300WPCS	\$4,290
		Bone/Biscuit/Almond	PET300WPCSB	\$4,407
		Other Colors*	PET300WPCSGRP1	\$4,555
	Includes: - Whirlpool system with 5 point-massage jets, - Fill-Flush® cleaning system - Suction fitting with removable screen filter to trap hair, - Hot/cold single-lever mixing valve, hand-held shower, Breda Valve Diverter (all in chrome finish) - Unit will fill through the jets. - 2 suction-mounted movable retaining rings and 1 adjustable loop-style restraint.	White	PET300WPC	\$4,936
		Bone/Biscuit/Almond	PET300WPCB	\$5,121
		Other Colors*	PET300WPCGRP1	\$5,291

Lead Time - 7 business days (any configuration)

Tub Options / Accessories & Hardware for all Packages

Drain & Overflow Kits - other finishes also available - see p. C-10

Cable Driven - Chrome (WOCD) **\$258**; Brushed Nickel (WOCDBN) **\$280**
 Polished Nickel (WOCDPN) **\$389**; Oil-Rubbed Bronze (WOCBOR) **\$396**
 Color matched with tub - standard tub colors only (WOCDW) **\$256**
 Toe-Tap - Chrome (WOTTC) **\$194**; Brushed Nickel (WOTTBN) **\$202**
 Polished Nickel (WOTTPN) **\$264**

Breda Valve - Brushed Nickel finish upcharge (JPTBNB) **\$99**

Breda Valve / Mixing Valve / Filler Spout / Hand-Held Shower

Brushed Nickel finish upcharge (JPTBNMBH) **\$189**

Trim Kit - for jets and controls

Chrome (TRC) **\$216**; Brushed Nickel (TRBN) **\$398**

Quick Ship - reduces lead time - please call for availability (QSPRI) **\$299**

Standard Features for All Packages

- Durable Lucite cast acrylic shell is extremely scratch- and stain-resistant, yet renewable because the color goes all the way through the shell.
- Non-porous surface makes cleaning / sanitizing faster & more effective.
- Reinforcement of multi-layer backing of thick fiberglass / resin / titanium.
- Integral tile flange on 3 sides.
- Molded-in shelves for shampoos and supplies.
- Integral removable acrylic skirt.
- Pre-Leveled frame system.
- Slip-resistant adhesive-backed material for tub floor is included, but not installed.